

EXPLORE ENGAGE IMAGINE

FUTURE HEALTHCARE PROFESSIONALS' EXPERIENCE

**Saturday, March 25, 2023
8 a.m. - 3 p.m.
Lubbock, TX**

#FHPE

Schedule for the Day

8:00-8:30 Check-in ACB Lobby

8:30-9:30 Welcome / Trauma Simulation ACB 100

9:35-10:20 Overview Sessions:

Graduate Medical Education Sciences: Med School Prep and You
Graduate School 1C102

School of Health Professions Overview
Health Professions ACB 120

How to Save a Life: A Day in the Life of a Nurse
Nursing SimLife

What All Can A Pharmacist Do? More than you think!
Pharmacy 1C110B

What is Population and Public Health?
Population & Public Health 1C124

Admissions Sessions:

GSBS Application Process
Graduate School 1C100

How to Become a Competitive Applicant for Medical School
Medicine ACB 100

Nursing Admissions 101: Basics to Becoming a Red Raider Nurse
Nursing ACB 150

Let's Go to Pharmacy School
Pharmacy 1C110A

10:25-11:10 Overview Sessions:

Graduate Medical Education Sciences: Med School Prep and You
Graduate School 1C102

School of Health Professions Overview
Health Professions ACB 120

10:25-11:10 continued

Rural Health Care: Help Needed and State/Federal Programs to
Help Pay for Educational Debt

Medicine

ACB 110

How to Save a Life: A Day in the Life of a Nurse

Nursing

SimLife

What All Can a Pharmacist Do? More than you think!

Pharmacy

1C110B

What is Population and Public Health

Population and Public Health

1C124

Admissions Sessions:

GSBS Application Process

Graduate School

1C100

Journey to Medical School & Outreach Programs

Medicine

ACB 100

Nursing Admissions 101: Basics to Becoming a Red Raider Nurse

Nursing

ACB 150

Let's Go to Pharmacy School

Pharmacy

1C110A

--Optional Tour--

ACB Lobby

11:15-12:00 Overview Sessions:

Graduate Medical Education Sciences: Med School Prep and You

Graduate School

1C102

School of Health Professions Overview

Health Professions

ACB 120

Medical Student Panel

Medicine

ACB 110

How to Save a Life: A Day in the Life of a Nurse

Nursing

SimLife

What All Can a Pharmacist Do? More than you think!

Pharmacy

1C110B

11:15-12:00 continued

What is Population and Public Health
Population and Public Health 1C124

Admissions Sessions:

GSBS Application Process
Graduate School 1C100

Joint Admissions Medical Program
Medicine ACB 100

Nursing Admissions 101: Basics to Becoming a Red Raider Nurse
Nursing ACB 150

Let's Go to Pharmacy School
Pharmacy 1C110A

--Optional Tour-- ACB Lobby

12:00-1:15 Lunch & Resource Fair Academic Event Center (AEC)

1:15-1:30 Closing Academic Event Center (AEC)

1:30-2:15 --Optional Tour-- ACB Lobby

2:15-3:00 --Optional Tour-- ACB Lobby

Win TTUHSC Swag!

Make sure to stop by the Resource Fair for a chance to win a giveaway of TTUHSC swag items. A card will be given to you at the start of the resource tables which you can get punched by visiting each table. Turn your card in to be entered into the drawing!

--TOURS AVAILABLE--

10:25-11:10

11:15-12:00

1:30-2:15

2:15-3:00

Institute of Anatomical Sciences Tours
Anatomy

SimLife Center Tours
Nursing

Laboratory Tours
Graduate School

****To schedule a tour please stop by the Tour table in the 1st Floor
ACB Lobby. We have limited spots available.**

****When it's time for your tour, please go to the Tour table to wait for
your guides.**

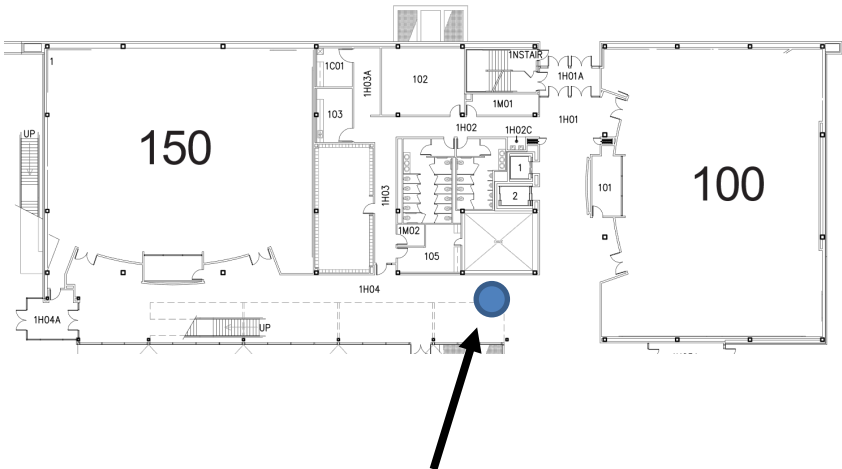

Plan Your Day:

9:35-10:20 **Session:** _____

Room #: _____

10:25-11:10 **Session:** _____

Room #: _____

11:15-12:00 **Session:** _____

Room #: _____

1:30-2:15 **Session:** _____

Room #: _____

2:15-3:00 **Session:** _____

Room #: _____

Breakout Session Descriptions

Graduate School of Biomedical Sciences

Graduate Medical Education Sciences: Med School Prep and You

Designed for students whose goal is a teaching career in medical education, or who need additional prep for medical school, students take courses with first-year medical students, and participate as teaching assistants. Students take courses in the anatomical and physiological sciences with the first-year medical students and in modern instructional methods and design, and will participate in the teaching mission of the medical school as teaching assistants, aiding in our abilities to spread positive, advanced health care to communities in west Texas and across the world.

GSBS Application Process

At the Graduate School of Biomedical Sciences, we are educating the next generation of scientists and health-related professionals in a dynamic, diverse and productive research environment that fosters creativity and discovery. Learn more about the programs we offer, and best practices and tips for applications!

Jerry H. Hodge School of Pharmacy

What All Can a Pharmacist Do? More Than You Think!

Do pharmacists only count pills and put them in a bottle? Do they just stand behind a counter all day? Not at all! Pharmacists are experts in drug therapy who work in pharmacies in many health care settings, not just in pharmacies but in hospitals, clinics and many other places. While they do oversee the preparation and dispensing of medication, they have many other roles. They work directly with other health professionals to help ensure safe and appropriate therapy, and also can work directly with patients to manage medical conditions. They are caring, trustworthy and the most accessible member of the healthcare team! Come to this session to learn more about the career paths of pharmacy and see if you're a good fit to be a future pharmacist!

Let's Go to Pharmacy School!

Are you interested in pharmacy school but you have no idea where to begin? Come learn about the steps you can take NOW to get started on your path to pharmacy. We will discuss ways to gain experience, what courses you should plan to take in college and the application process. BONUS – a bachelor's degree is NOT required!

Julia Jones Matthews School of Population and Public Health

What is Population and Public Health?

The Julia Jones Matthews School of Population and Public Health is the sixth and newest school at the TTUHSC. Come discover what population and public health is and what you can do with this versatile degree.

School of Health Professions

School of Health Professions Overview

We offer 20 different programs, all leading directly to careers critical to the healthcare industry. Programs include – Physician Assistant (PA), Physical Therapy (PT), Occupational Therapy (OT), Medical Laboratory Science (Pre-Med Option), Athletic Training, Clinical Counseling & Mental Health, Healthcare Administration, Speech-Language Pathology, Audiology, Molecular Pathology, and more! Come and learn more about your future in health care.

School of Medicine

How to Be a Competitive Applicant

Hear from the School of Medicine Office of Admissions, about the process of applying and becoming a competitive applicant. Additionally, we will discuss curriculum and how our unique structure benefits our medical students.

Joint Admission Medical Program (JAMP):

The Joint Admission Medical Program (JAMP) is a special program created by the Texas Legislature to support and encourage highly qualified, economically disadvantaged Texas resident students pursuing a medical education.

Journey to Medical School & Outreach Programs:

Join us on a step by step guide on your journey from high school to medical school. Learn about our outreach programs you can participate in throughout your journey.

Medical Student Panel:

This will be a session that you will be able to hear first-hand, from a panel of current medical students. Format will be Question/Answer.

School of Medicine (continued)

Rural Health Care: Help Needed and State/Federal Programs to Help Pay for Educational Debt:

Introduction to rural medicine health care disparities, discussion of FMAT PB, the rural FM residencies and state and federal educational debt scholarship and loan repayment programs.

School of Nursing

Nursing Admissions 101: Basics to Becoming a Red Raider Nurse

No matter where you are in your nursing journey, we have a path for you to become a Red Raider Nurse! Come learn more about our Traditional BSN, Accelerated BSN, and RN to BSN programs from our School of Nursing Admissions Coaches to help you decide which pathway is right for you.

How to Save a Life: A Day in the Life of a Nurse

Want to get a glimpse into the life of a nurse? Look no further! TTUHSC School of Nursing students will show you life-saving measures used by nurses every day to serve their patients.

Information for TTUHSC Schools:

Texas Tech University Health Sciences Center

website: www.ttuhsc.edu

Graduate School of Biomedical Sciences

website: www.ttuhsc.edu/biomedical-sciences

Jerry H. Hodge School of Pharmacy

website: www.ttuhsc.edu/pharmacy

Julia Jones Matthews School of Population and Public Health

website: www.ttuhsc.edu/population-public-health/default.aspx

School of Health Professions

website: www.ttuhsc.edu/health-professions

School of Medicine

website: www.ttuhsc.edu/medicine

School of Nursing

website: www.ttuhsc.edu/nursing

Resource Tables:

F. Marie Hall Institute for Rural and Community Health

website: www.ttuhsc.edu/rural-health

Financial Aid:

website: www.ttuhsc.edu/financial-aid

Joint Admissions Medical Program, JAMP:

website: www.texasjamp.org/

LEARN Educational Opportunity Center:

website: www.learnprograms.org/

TTU Athletic Program:

website: www.depts.ttu.edu/pphc/areas/athletictraining.php

U.S. Army Recruiting:

website: <https://recruiting.army.mil/mrb/>

Map of TTUHSC

Academic Event Center

Academic Classroom Building
1st Floor

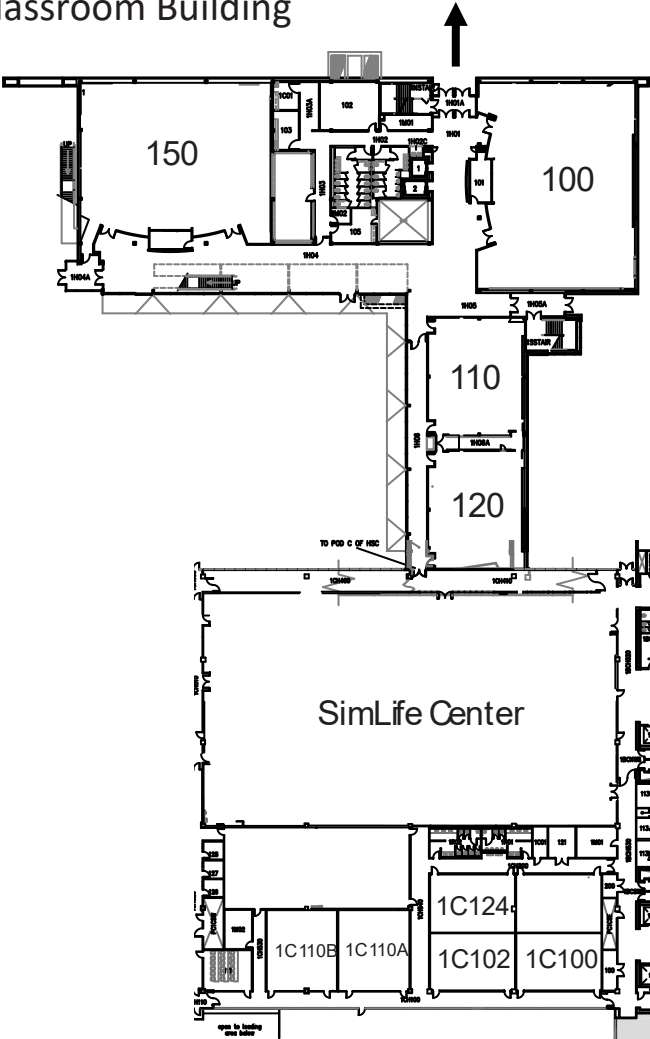



Thank you for your attendance at
this year's Future Healthcare
Professionals' Experience.